

# Regional Economy meeting

Henrik Egholm  
1 November 2018



**Ørsted**

## Ørsted team participating at todays event



Claus Bøjle Møller

Programme Director



Flemming Thomsen

Programme Director



Chris de Borst

Finance Manager



Klaasjaap Buijs

Construction Manager



Marjolein Hormes

Asset Manager



Steven Engels

General Manager Continental  
Western Euro



Joyce Goijaarts

HR Business Partner



Steen Carsten Larsen

Operations Manager



Henrik Egholm

EPC Director



Filip Engel

Sustainability Public Affairs &  
Branding



Stefan De Bruijn

Media Relations NL

# Project summary

Project Specific Characteristics		Key data and location	
Location	<ul style="list-style-type: none"> <li>Borssele site 1 &amp; 2 (BSW01+02), Zeeland, South West of The Netherlands</li> <li>Two adjacent 380MW sites</li> </ul>	Capacity	752 MW
		Size of the site	112 km <sup>2</sup>
Subsidy	<ul style="list-style-type: none"> <li>CFD: 72.7 EUR/MWh (nom.) w. floor price of 29 EUR/MWh</li> <li>Duration: 15 years fixed + 1 year extension</li> </ul>	Turbine type	Siemens – Gamesa 8MW
		Number of turbines	94
Modules	<ul style="list-style-type: none"> <li>Monopiles</li> <li>Array cable voltage 66kV</li> <li>On/offshore substation and export cable build by TenneT</li> <li>BSW01 and BSW02 connecting to the same offshore substation with a capacity of 700MW</li> </ul>	Water depth	39.7 m to 14.0 m
		Distance to shore (shortest)	22 km
Key Project dates	<ul style="list-style-type: none"> <li>Project award: 5 July 2016</li> <li>Substation energized: August 2019</li> <li><b>Construction: 2020</b></li> <li>First power deadline 5 July 2021 (5 years after award)</li> </ul>	Wind resource (at hub height)	9.5 m/s
		Length of offshore cable route	TenneT scope
Borssele map		Length of onshore cable route	TenneT scope
		O&M harbour	Vlissingen*
		Construction harbour	TBC
		Offshore substation	TenneT scope: 700 MW
		Onshore substation	TenneT scope
		Ørsted Ownership	100%
		Subsidy regime	CFD: 72.7 EUR/MWh

\*Subject to final agreement

# Borssele Site Overview and windfarm Layout

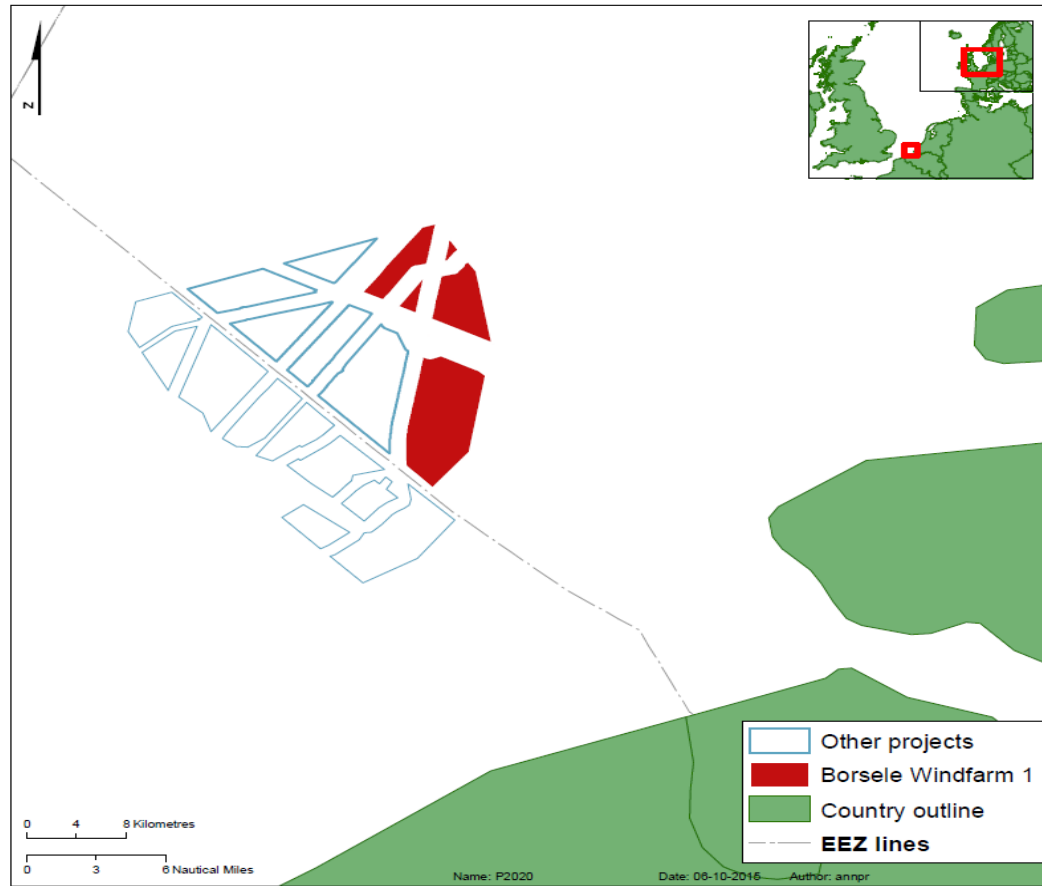

**DONG**  
ENERGY

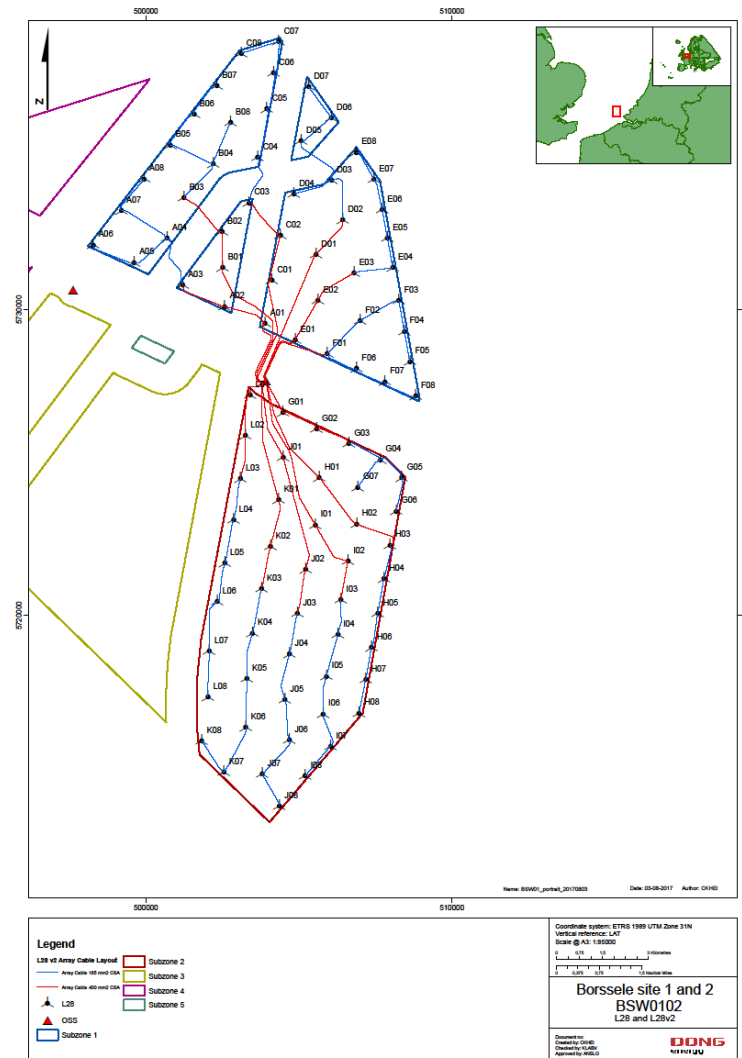

## Main Contractors for the assets and installation

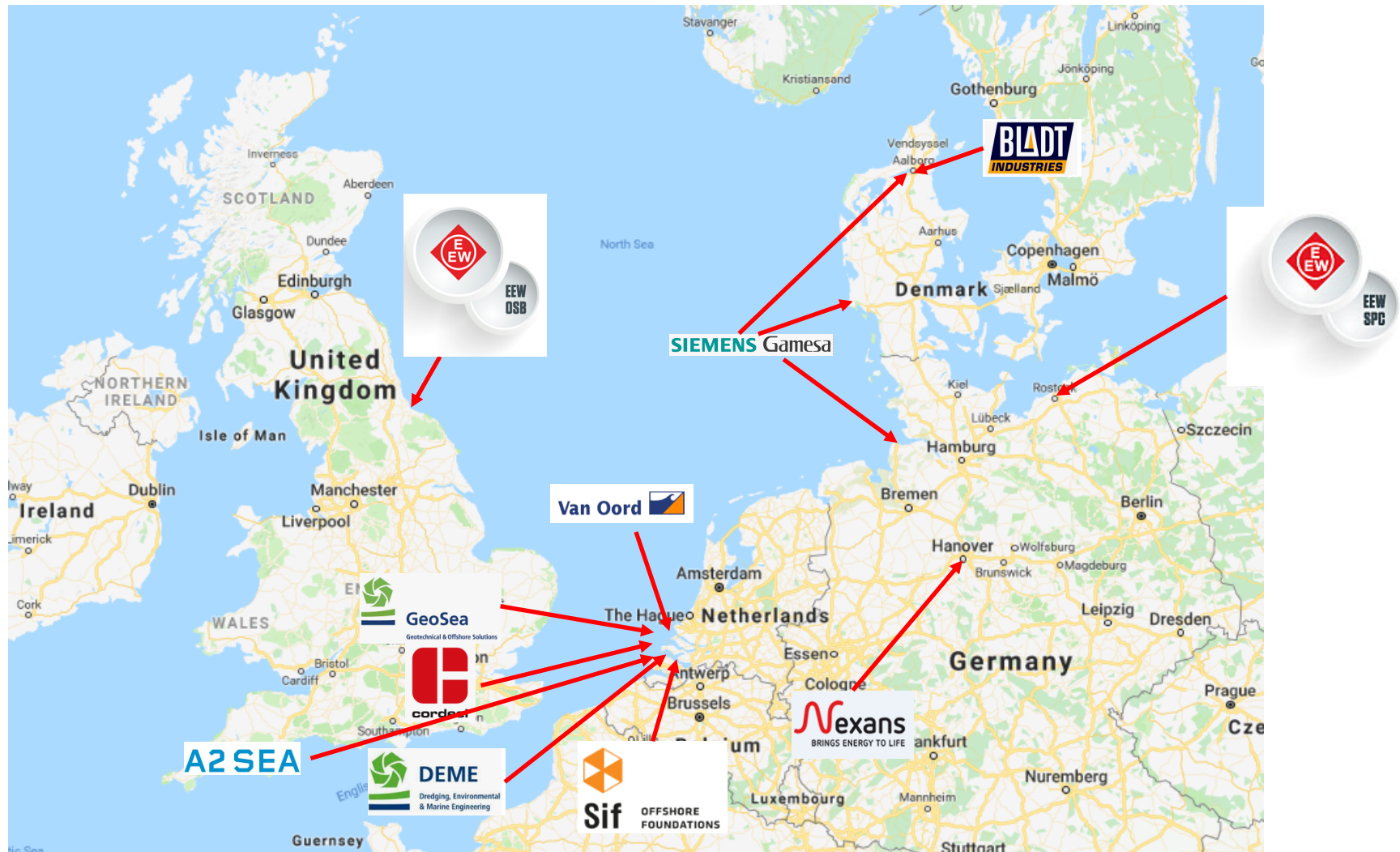

## 6



## BSW01+02 Construction building, Dutch companies to bring construction building



# Time Schedule

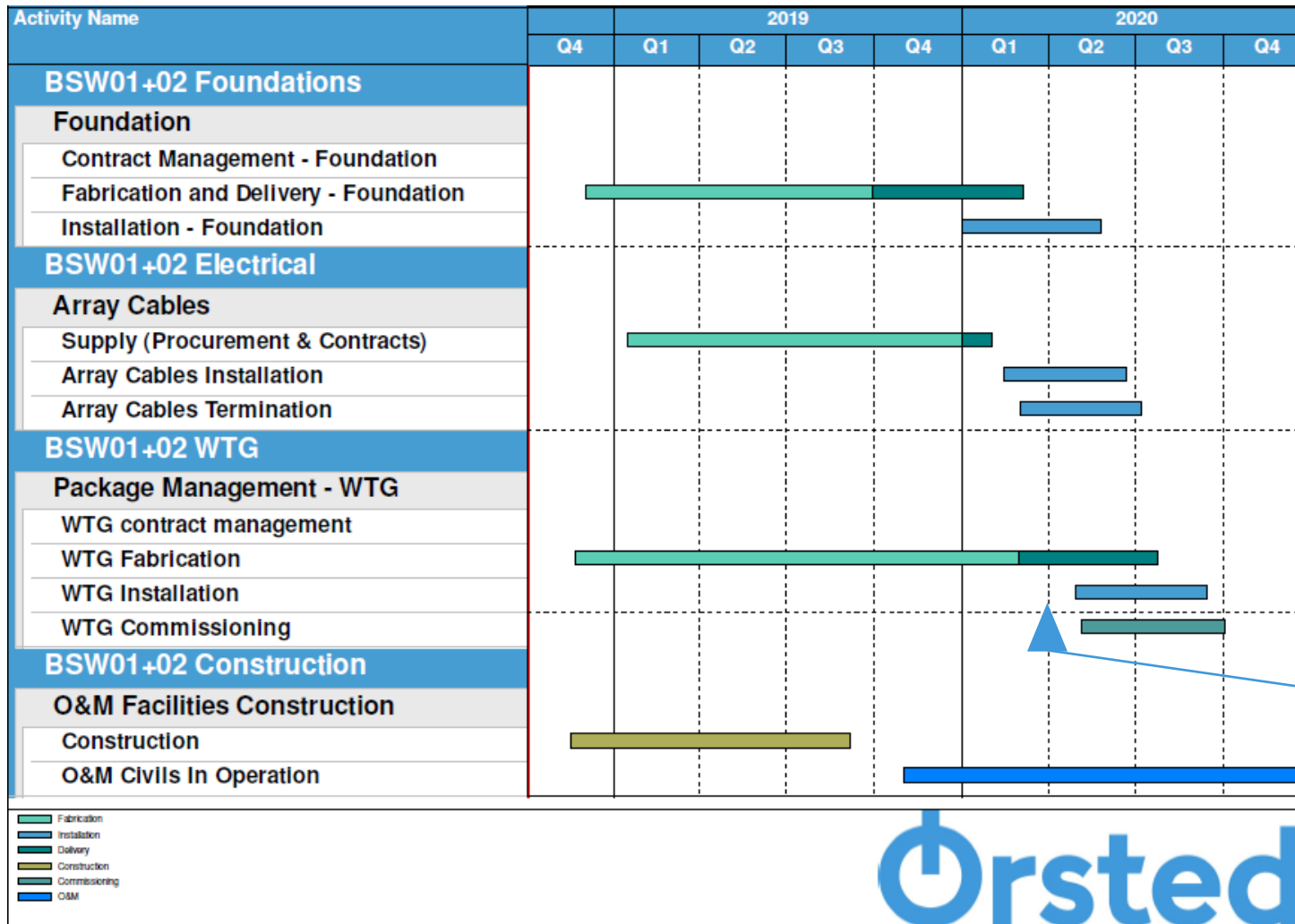

# BSW0102 Operational Set-up

Steen Carsten Larsen

Operations Manager

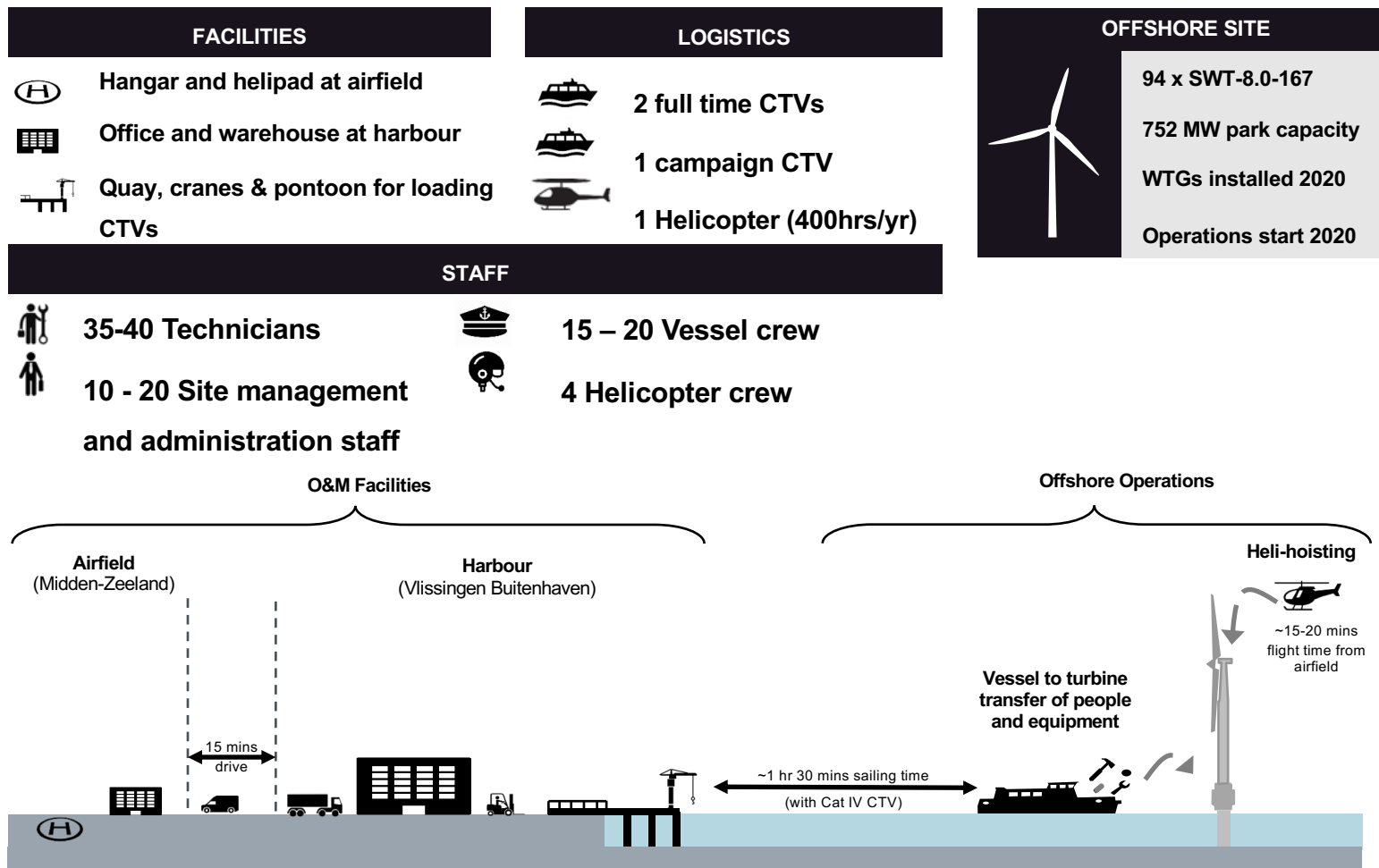

# O&M Facilities

## Safety & sustainability through design

- Robust separation between people and vehicles with dedicated delivery area.
- Building creates more power than it uses.

## Designed for flexible and efficient operations

- Sized for up to 60 technicians (i.e. 50% over staffing to provide flexibility for campaigns) and up to 20 office staff
- 2 floors: Mix of offices/changing rooms (~900 m<sup>2</sup>) and warehousing (~1,100 m<sup>2</sup>)
- Designed for efficient vessel operations:
  - Pontoons with berthing for 4 CTVs (incl. 1 maxi-CTV and compatibility with SES vessel confirmed)
  - Bunkering available at all pontoon berths.
  - Loading of CTVs at all berths possible with quayside cranes

## Timed to facilitate knowledge transfer

- EPC and site operations team to both use the O&M facilities during construction phase.

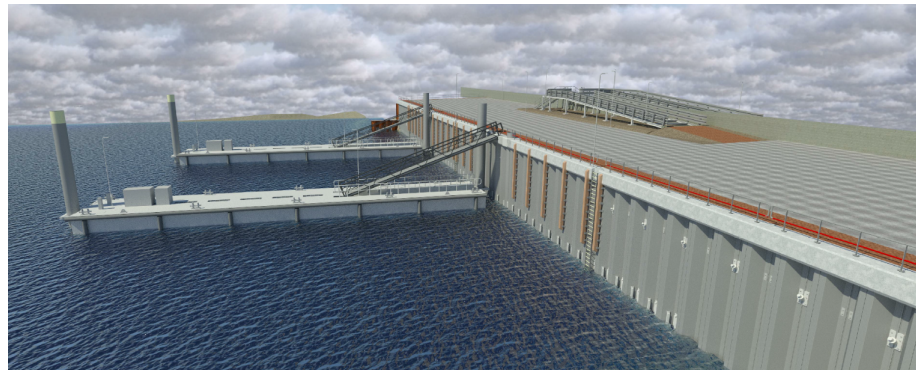

# Helicopter Operations Set-up

## Midden Zeeland Airport: Helicopter Supplier Scope

- Hangar & offices
- Security & customs service desk
- Passenger check-in & weighing
- Passenger handling + waiting area
- Cargo handling incl. dangerous goods
- Access to fuel facilities

